

HM122 ADJUSTABLE BLADE GUIDE INSTALLATION

STEP 1: REMOVE THE BLADE AND THE FOLLOWER SIDE BANDWHEEL .

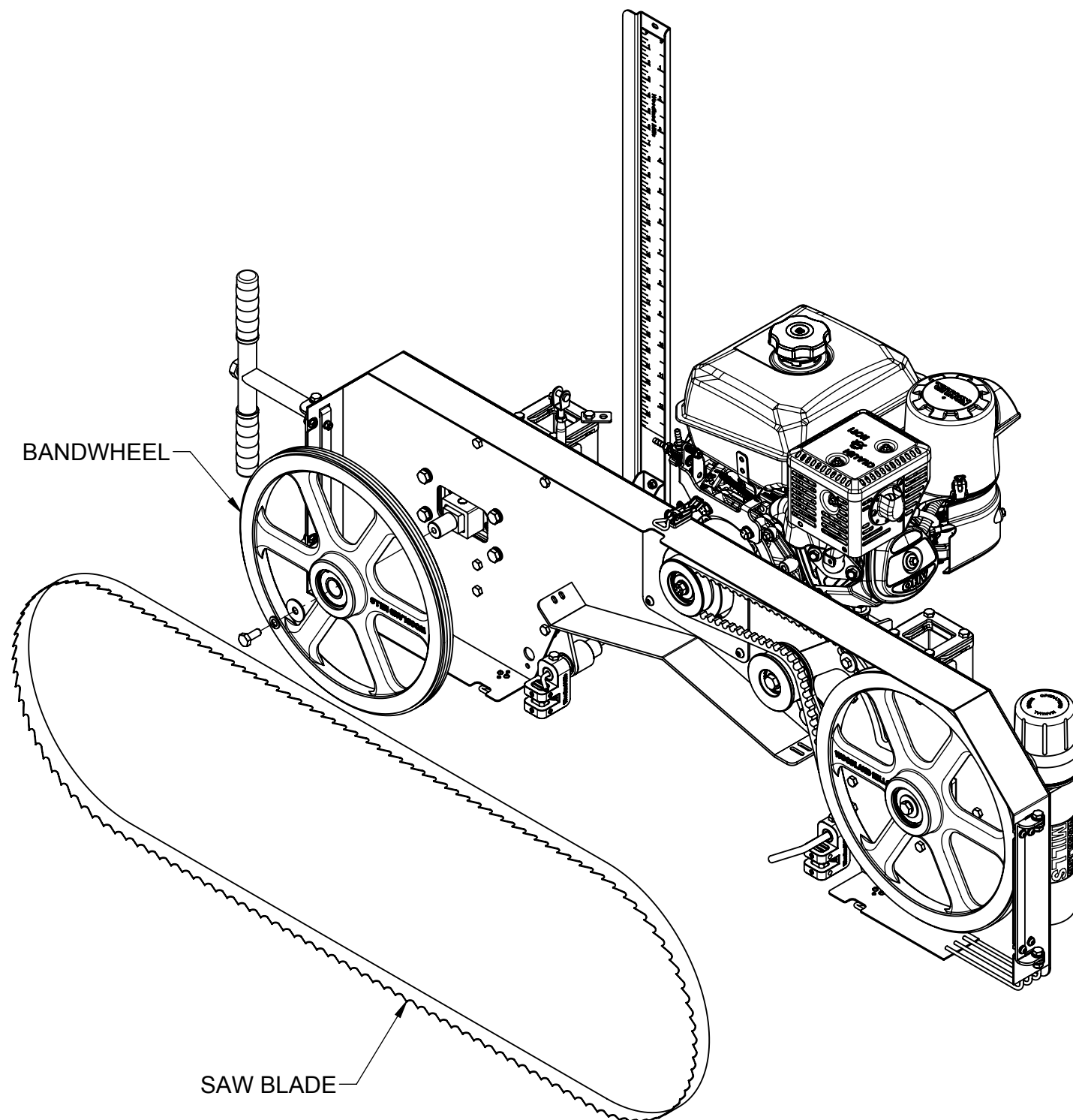

STEP 2: REMOVE THE RIGHT SIDE GUIDE BLOCK HOLDER AND SHAFT, THE BLADE GUIDE HOLDER BRACKET, AND SPACERS. ENSURE THAT THE TWO M8X20 HEX BOLTS ARE REMOVED AS WELL. KEEP THE SPACERS FOR REINSTALL. THE BLADE GUIDE HOLDER BRACKET AND OLD HARDWARE CAN BE DISCARDED.

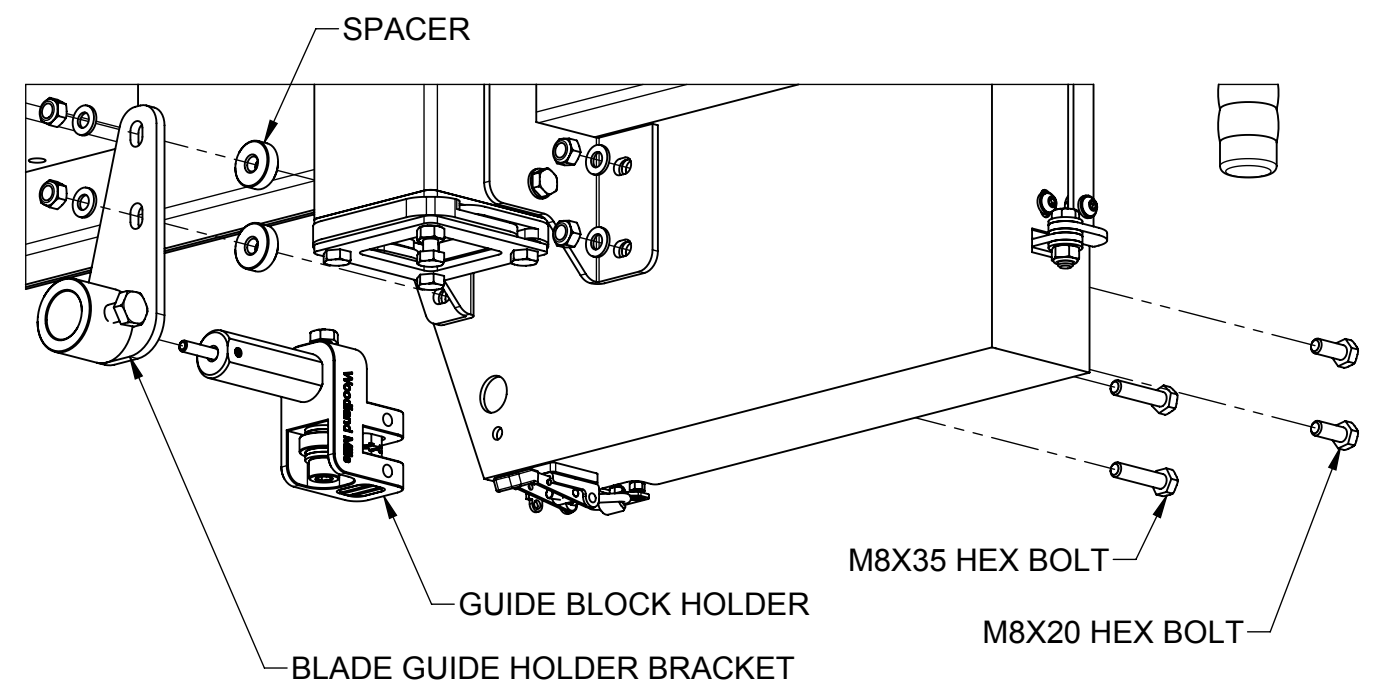

HM122 ADJUSTABLE BLADE GUIDE INSTALLATION

STEP 3: UNINSTALL THE GUIDE BLOCK HOLDER FROM THE SHAFT THAT WAS REMOVED IN STEP 2, AS SHOWN BELOW. THE GUIDE BLOCK HOLDER WILL BE REINSTALLED TO THE ADJUSTABLE BLADE GUIDE ASSEMBLY.

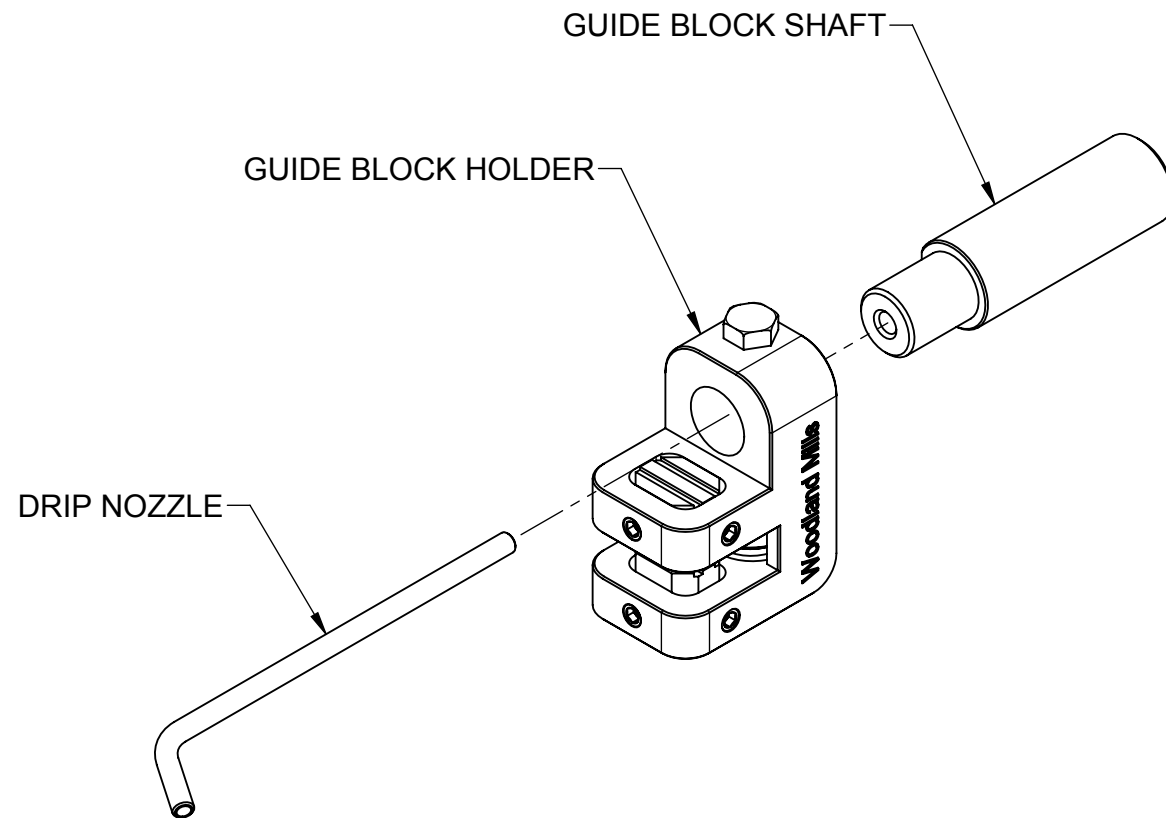

STEP 4: ASSEMBLE THE GUIDE BLOCK HOLDER, NEW GUIDE BLOCK SHAFT, AND ADJUSTABLE BLADE GUARD ARM AS SHOWN BELOW. INSTALL THE ZERK FITTING (NEW DRIP NOZZLE) ON THE SHAFT ONCE IT HAS BEEN SLID THROUGH THE ADJUSTABLE BLADE GUIDE ARM AND GUIDE BLOCK.

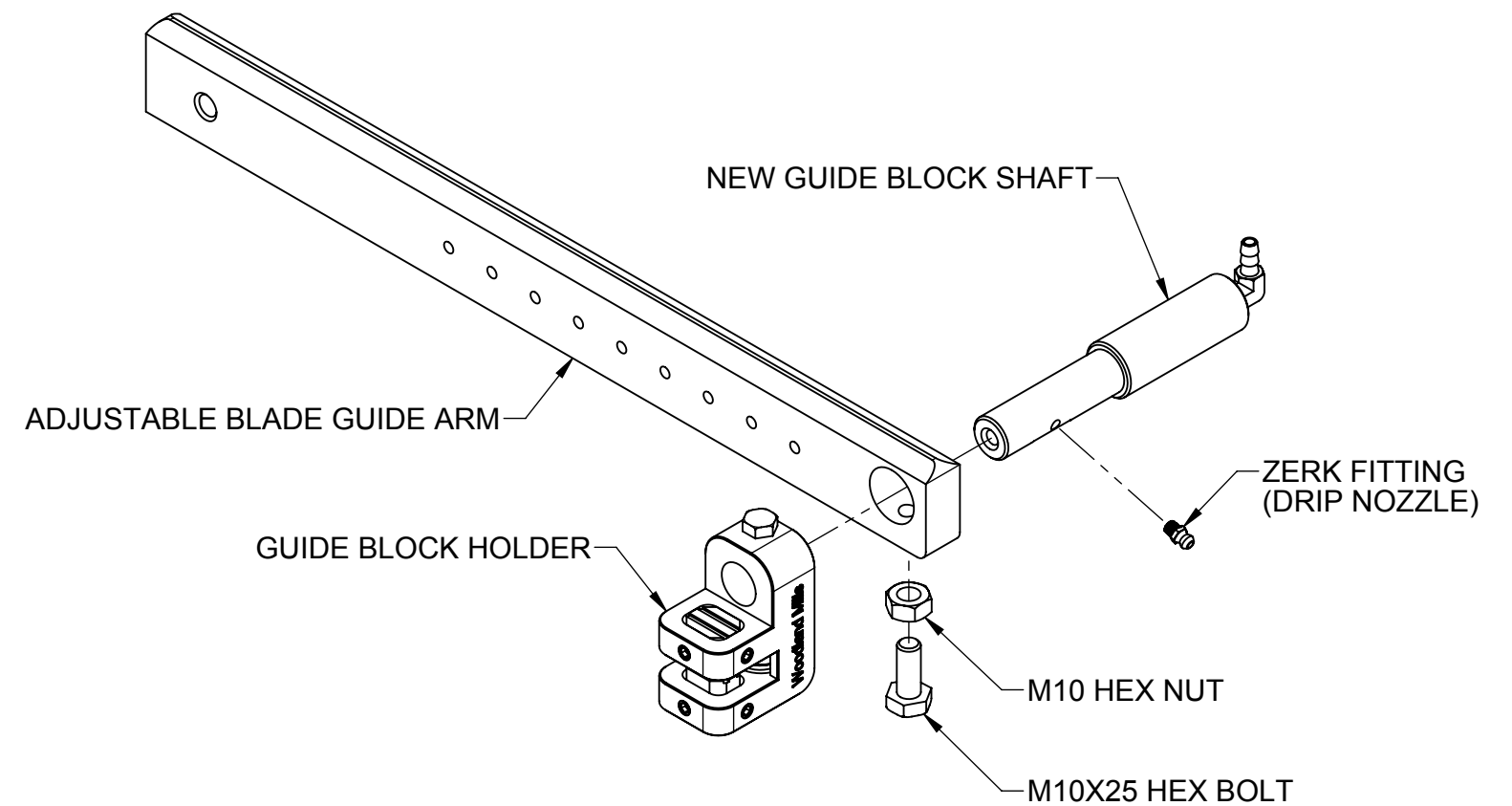

HM122 ADJUSTABLE BLADE GUIDE INSTALLATION

STEP 5: SLIDE THE ADJUSTABLE BLADE GUIDE ARM INTO THE V-ROLLERS ON THE CARRIAGE PLATE.

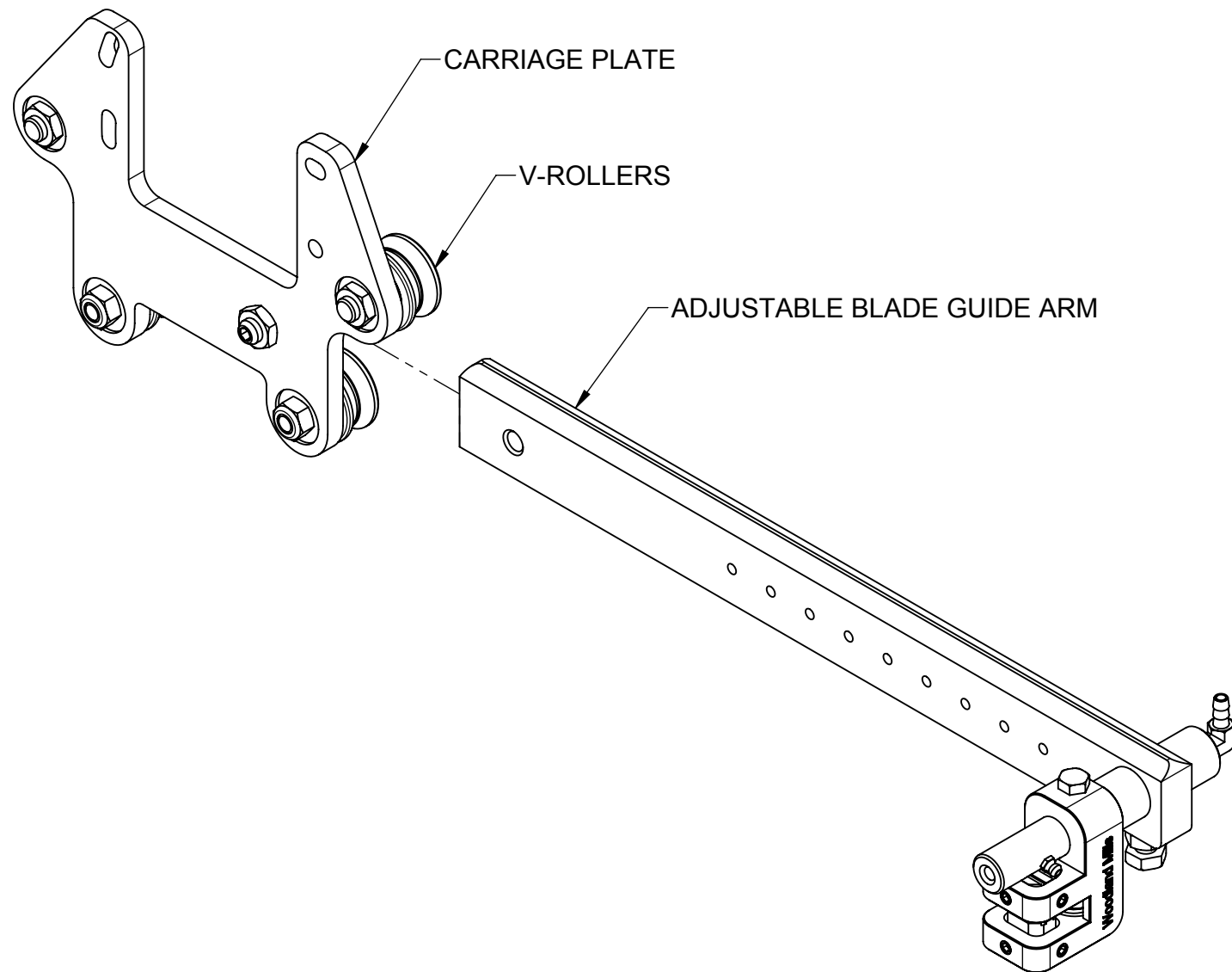

STEP 6: INSTALL THE PLASTIC HANDLE ON THE ADJUSTABLE BLADE GUIDE ARM AS SHOWN BELOW.

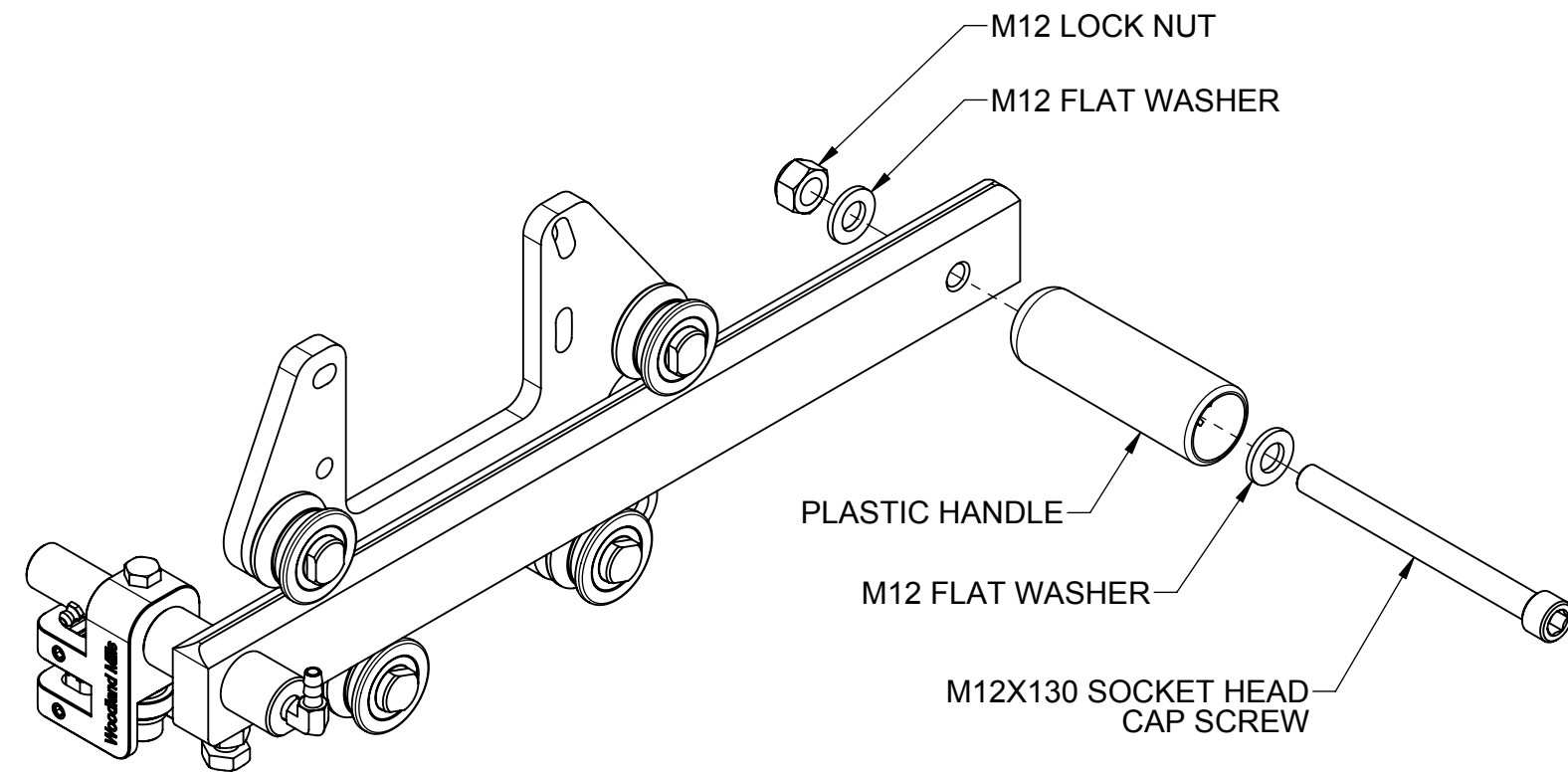

HM122 ADJUSTABLE BLADE GUIDE INSTALLATION

STEP 7: INSTALL THE NYLON WASHERS AND SPACER AS SHOWN BELOW. FULLY TIGHTEN THIS BOLT.

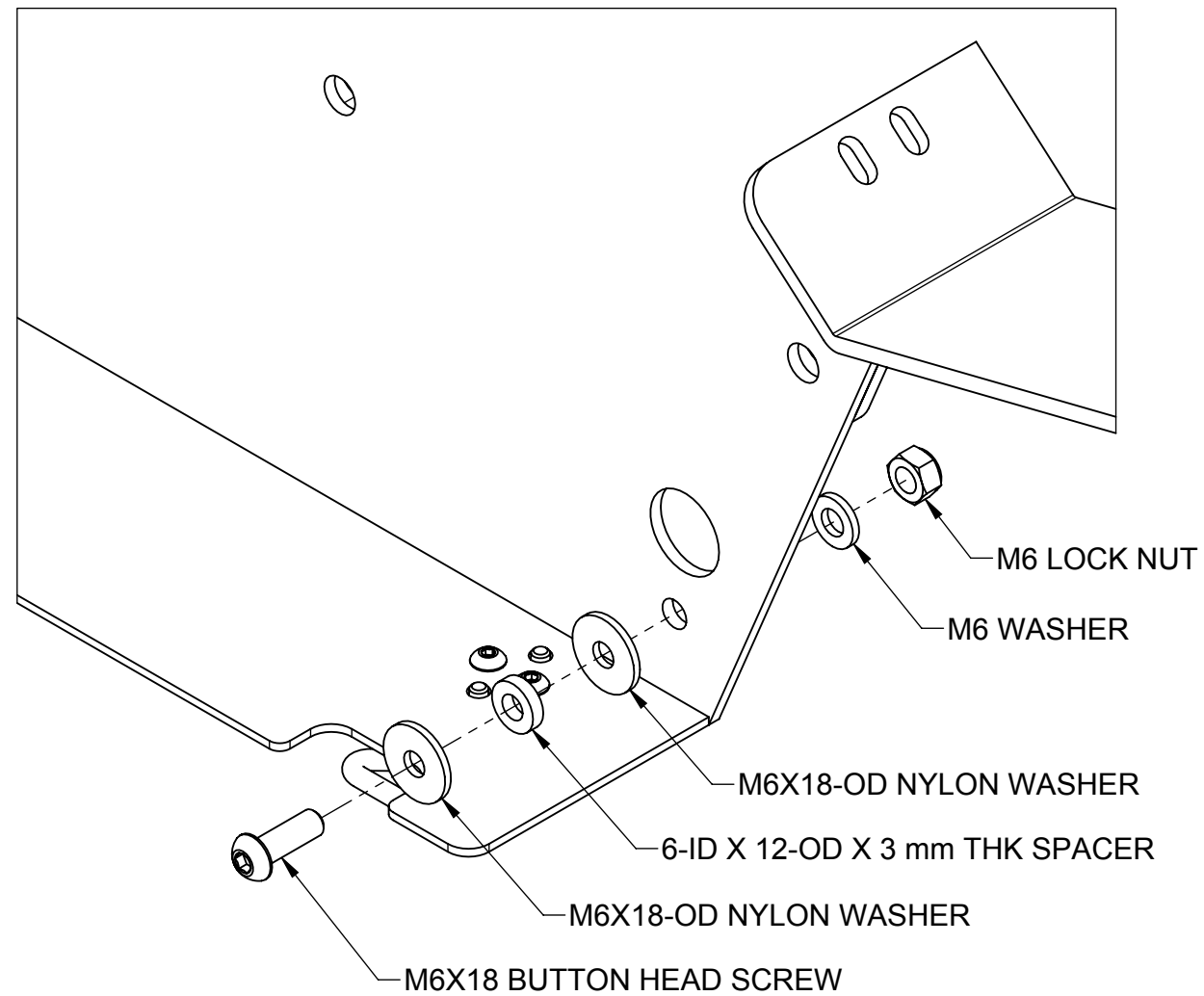

STEP 8: INSTALL THE ADJUSTABLE BLADE GUIDE ASSEMBLY ON THE RIGHT RIDE OF THE SAW HEAD USING THE HARDWARE SHOWN BELOW.

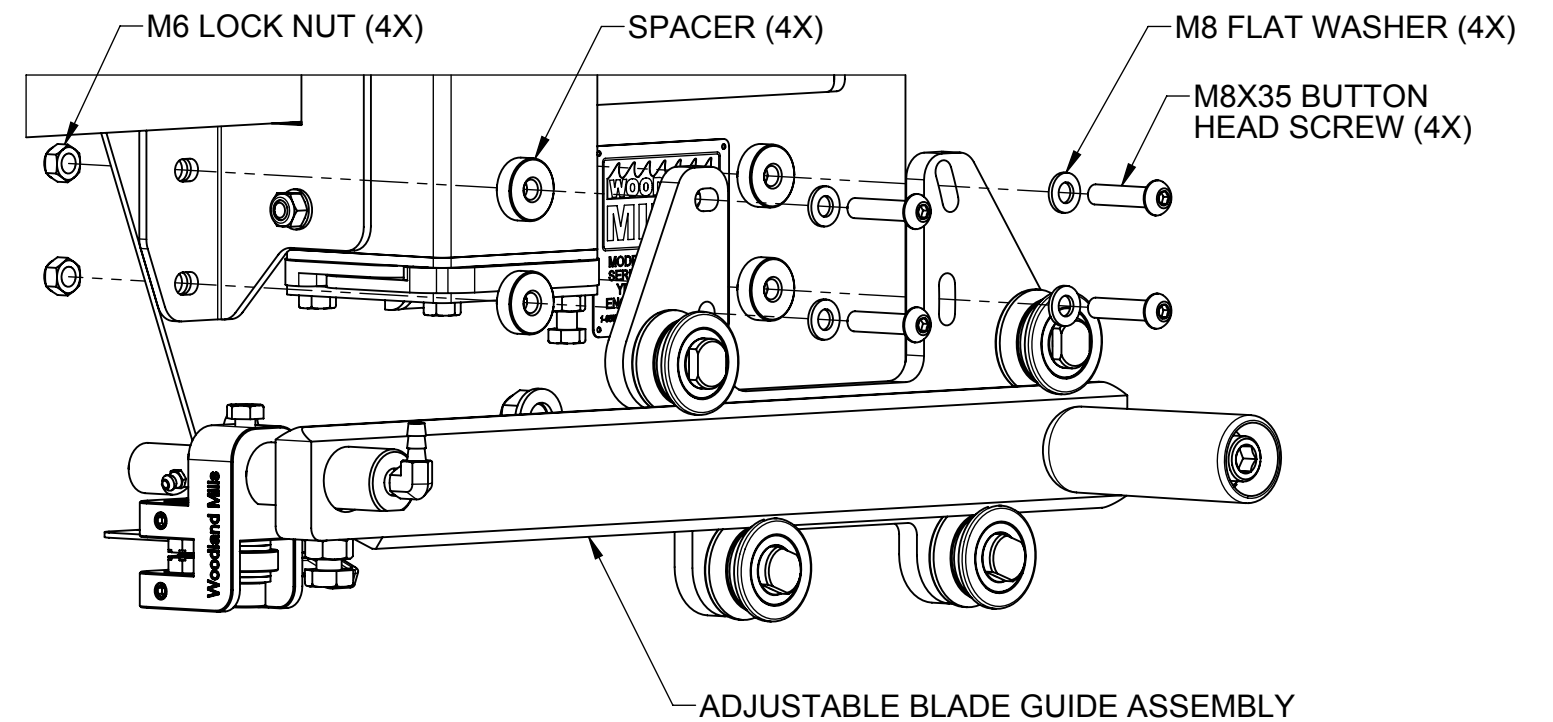

HM122 ADJUSTABLE BLADE GUIDE INSTALLATION

STEP 9: REINSTALL THE FOLLOWER BAND WHEEL AND SAW BLADE.

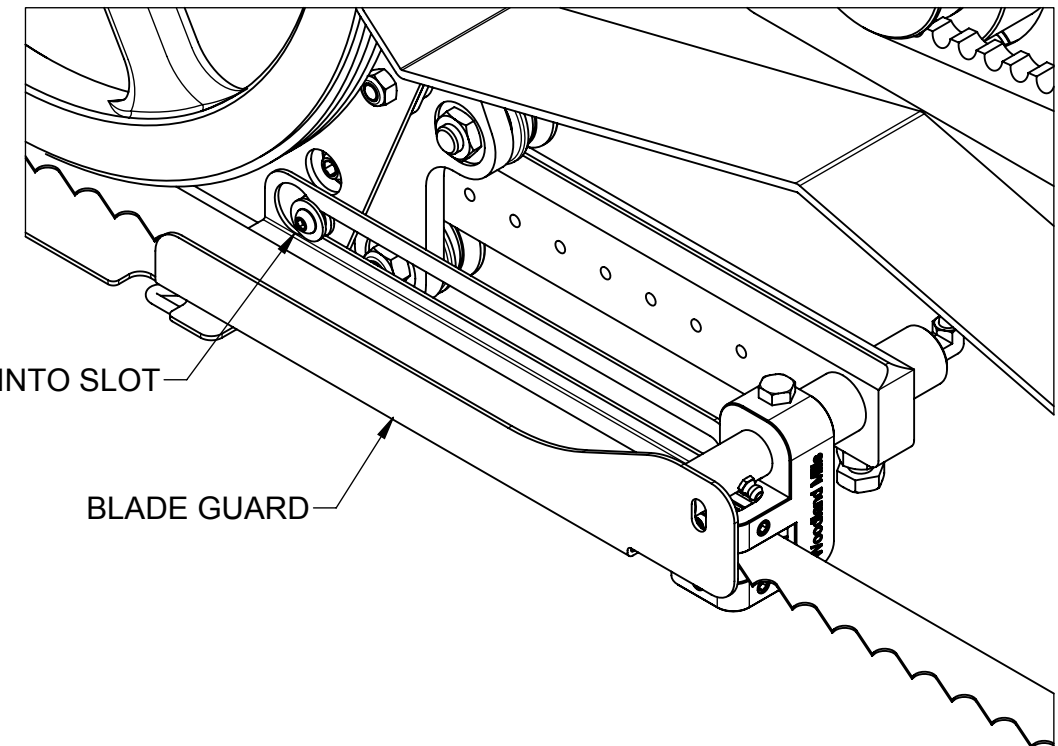
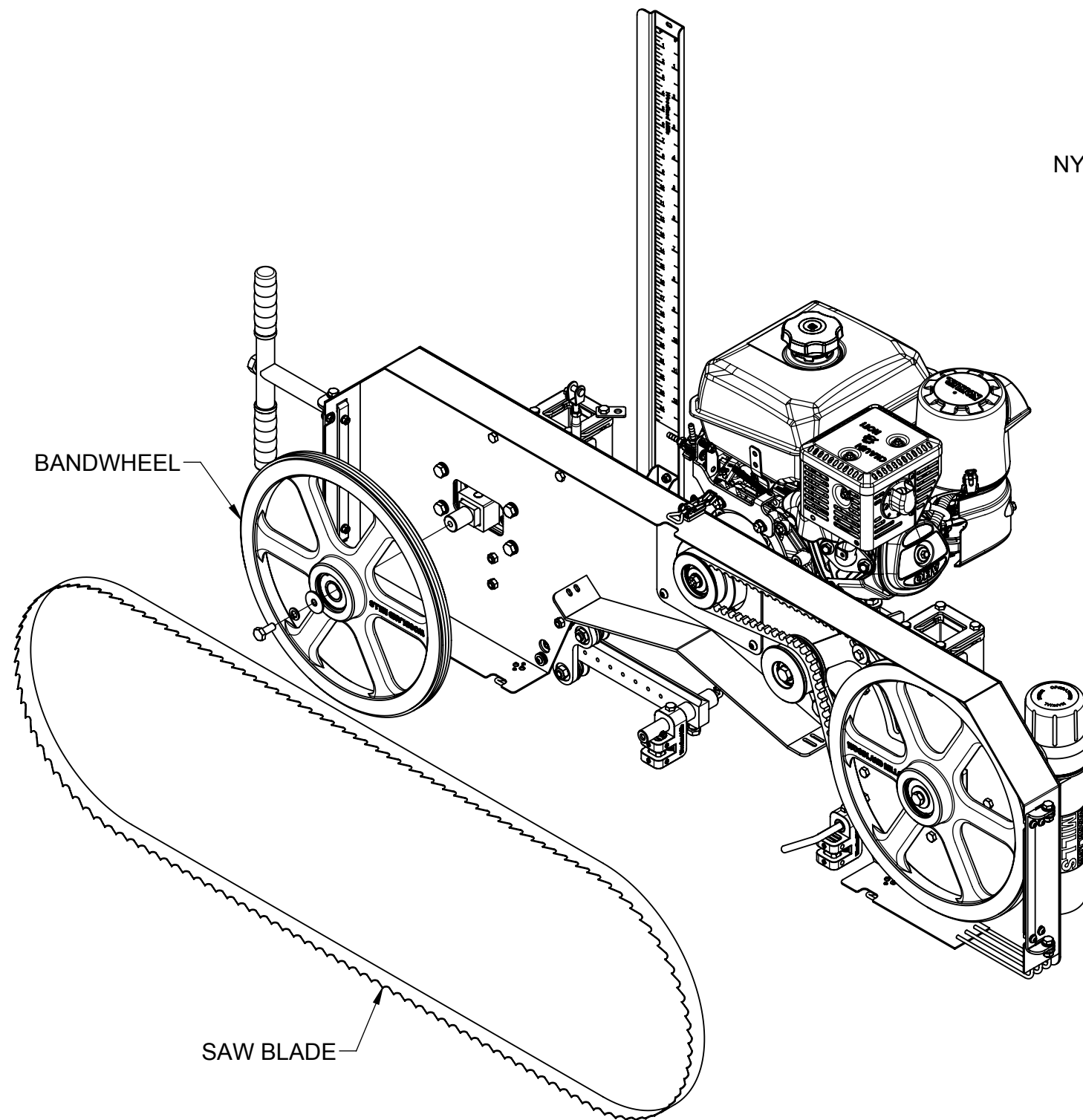

STEP 10: INSTALL THE YELLOW BLADE GUARD AS SHOWN. SLIDE THE SPACER WITH THE NYLON WASHERS INTO THE SLOT ON BLADE GUARD USING THE LARGE HOLE AT THE END (SHOWN ABOVE). ENSURE THE BLADE GUARD IS PARALLEL TO THE BOTTOM OF THE BANDWHEEL HOUSING AND SECURE IT IN PLACE USING THE THREADED KNOB (SHOWN BELOW).

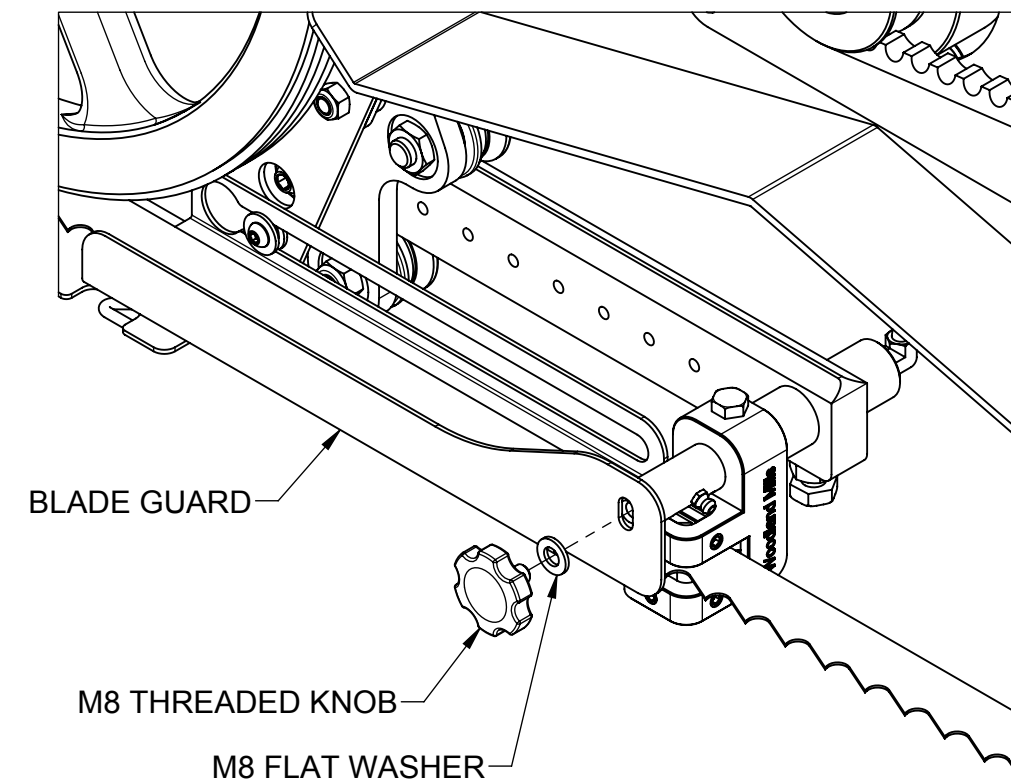

ALIGNING ADJUSTABLE BLADE GUIDE TO BLADE

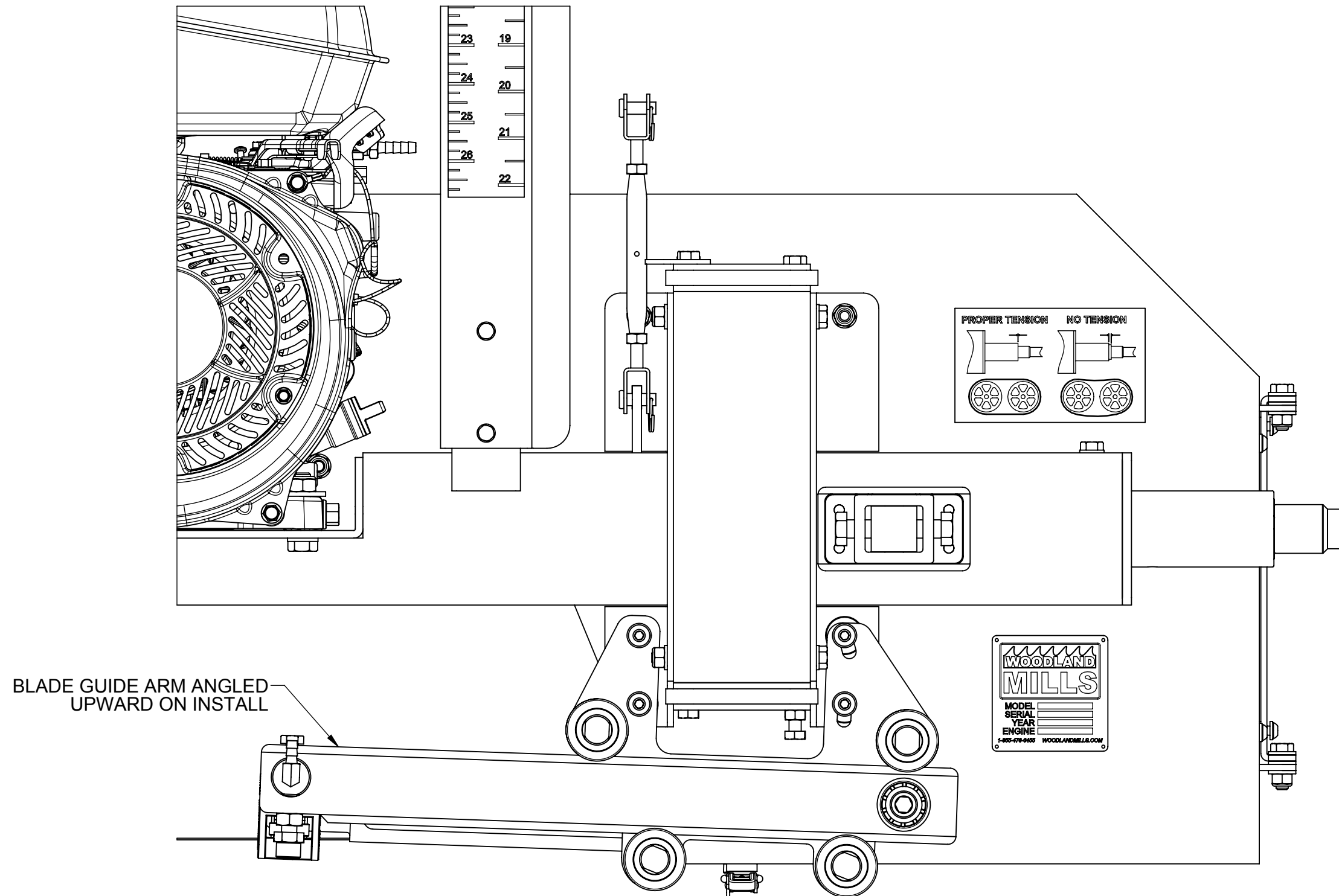

IF THE SAW BLADE IS SITTING LOW IN THE GUIDE BLOCK HOLDER (THE BLADE GUIDE ARM POINTS UPWARD), THE ADJUSTABLE BLADE GUIDE NEEDS TO BE ROTATED DOWN SO IT IS PARALLEL WITH THE SAW BLADE.

LOOSEN ALL FOUR (4) M8X35 BUTTON HEAD SCREWS SO THE WASHER CAN JUST SPIN FREELY. ROTATE THE BLADE GUIDE ARM DOWN UNTIL THE BLADE GUIDE ARM AND THE SAW BLADE ARE PARALLEL AND THE SAW BLADE IS CENTERED IN THE GUIDE BLOCK. REFER TO THE MANUAL FOR GUIDE BLOCK SETUP.

ALIGNING ADJUSTABLE BLADE GUIDE TO BLADE

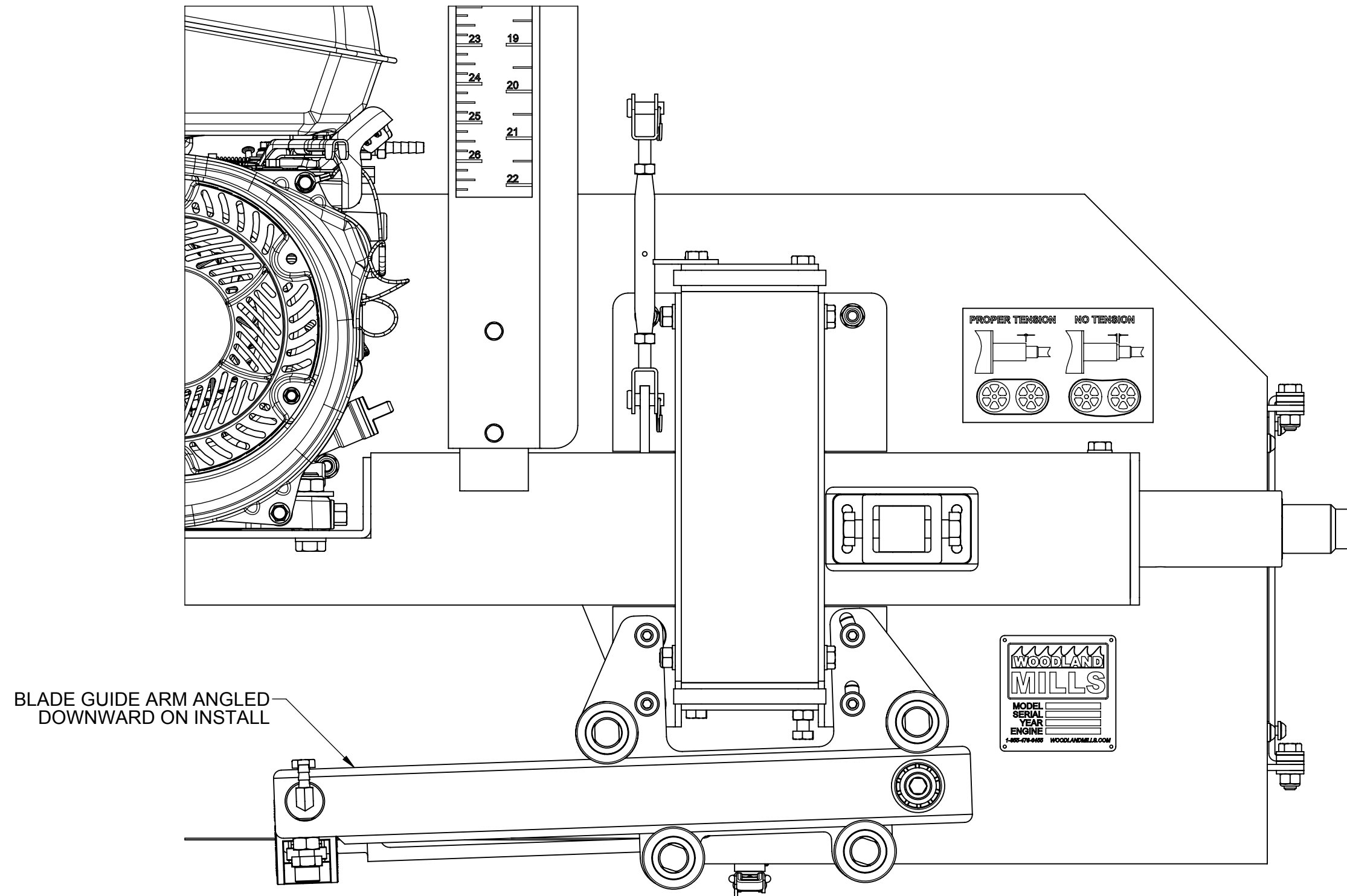

IF THE SAW BLADE IS SITTING HIGH IN THE GUIDE BLOCK HOLDER (THE BLADE GUIDE ARM POINTS DOWNWARD), THE ADJUSTABLE BLADE GUIDE NEEDS TO BE ROTATED UP SO IT IS PARALLEL WITH THE SAW BLADE.

LOOSEN ALL FOUR (4) M8X35 BUTTON HEAD SCREWS SO THE WASHER CAN JUST SPIN FREELY. ROTATE THE BLADE GUIDE ARM UP UNTIL THE BLADE GUIDE ARM AND THE SAW BLADE ARE PARALLEL AND THE SAW BLADE IS CENTERED IN THE GUIDE BLOCK. REFER TO THE MANUAL FOR GUIDE BLOCK SETUP.

GUIDE ROLLER ADJUSTMENT

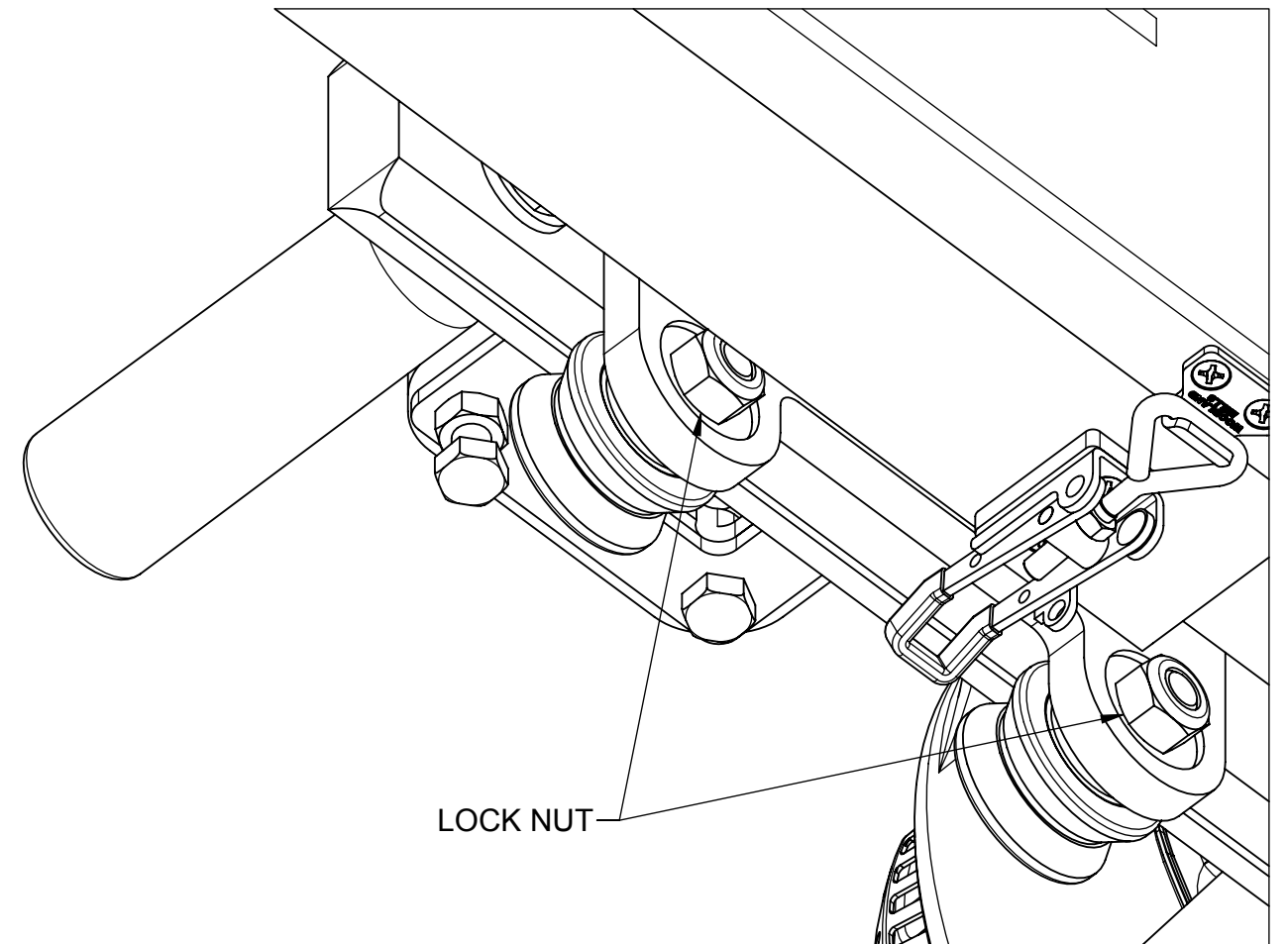
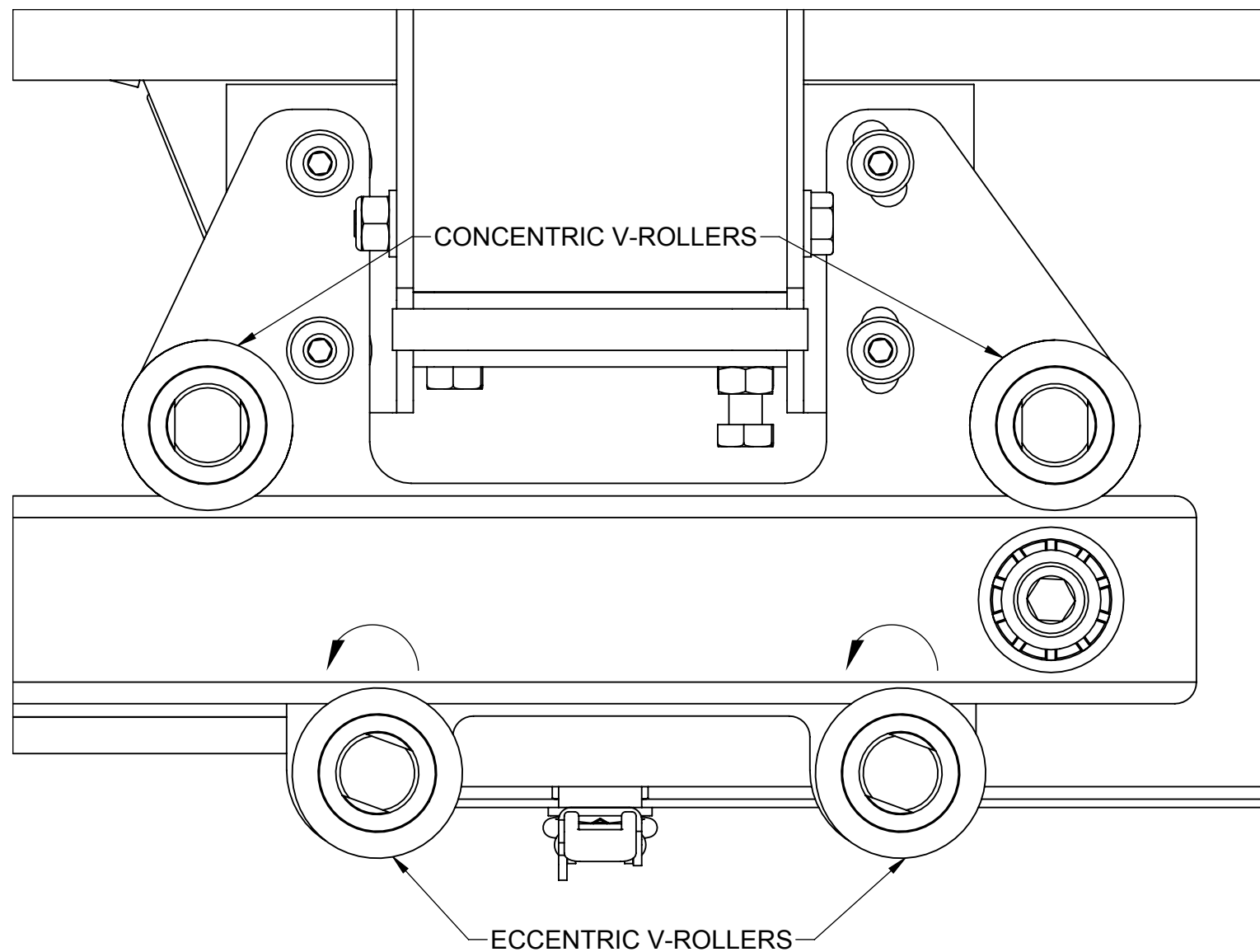

IF THE BLADE GUIDE ARM IS LOOSE IN THE V-ROLLERS, THE LOWER TWO (ECCENTRIC) V-ROLLERS NEED TO BE ROTATED COUNTER-CLOCKWISE (UPWARDS). LOOSEN THE LOCK NUTS ON THE OTHER SIDE OF THE CARRIAGE PLATE AND ROTATE THE V-ROLLER COUNTER-CLOCKWISE (UPWARD) SO THE V-ROLLERS MAKE PROPER CONTACT WITH THE BLADE GUIDE ARM. SECURE THE LOCK NUTS.

GUIDE ROLLER ADJUSTMENT

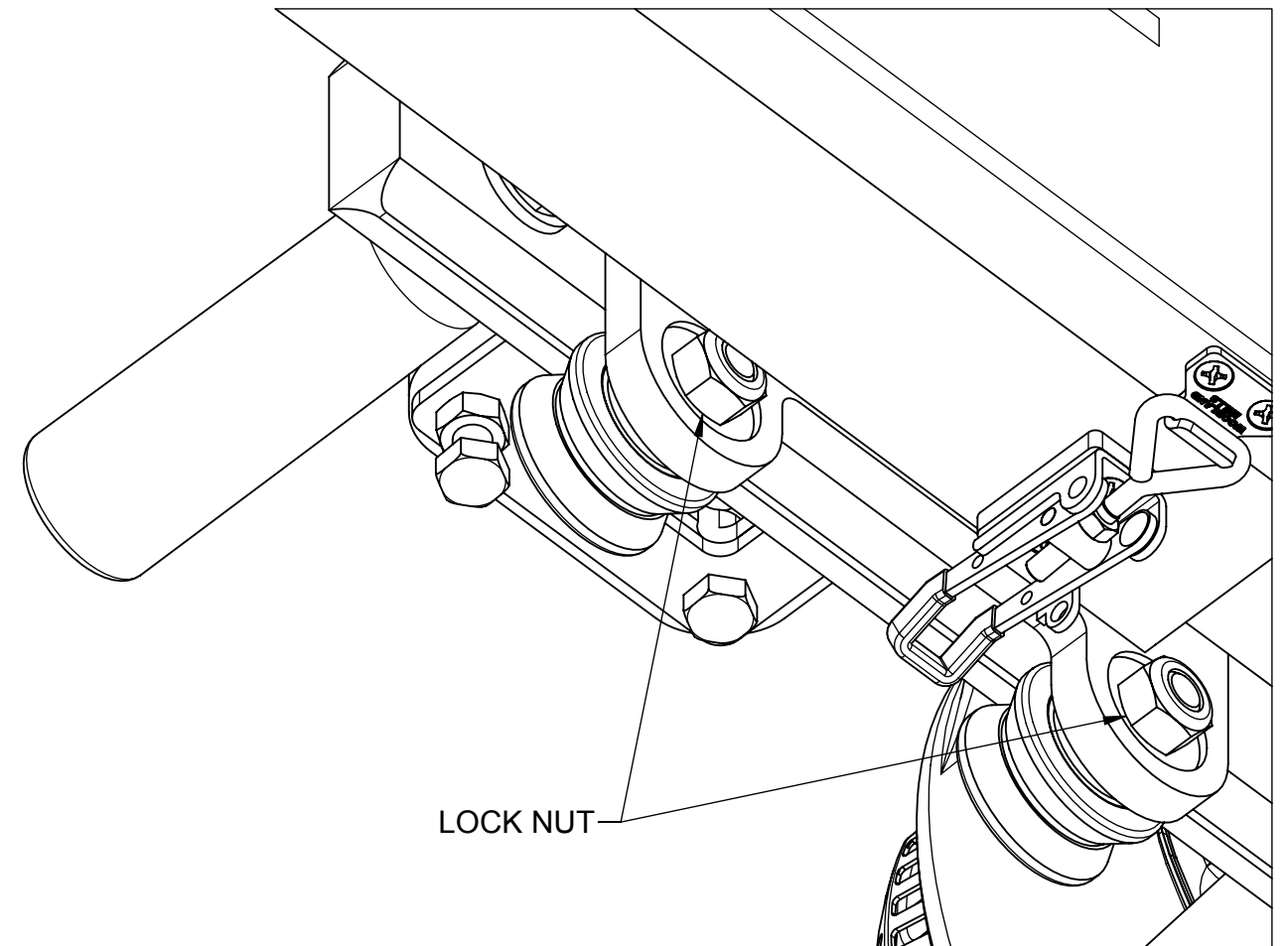
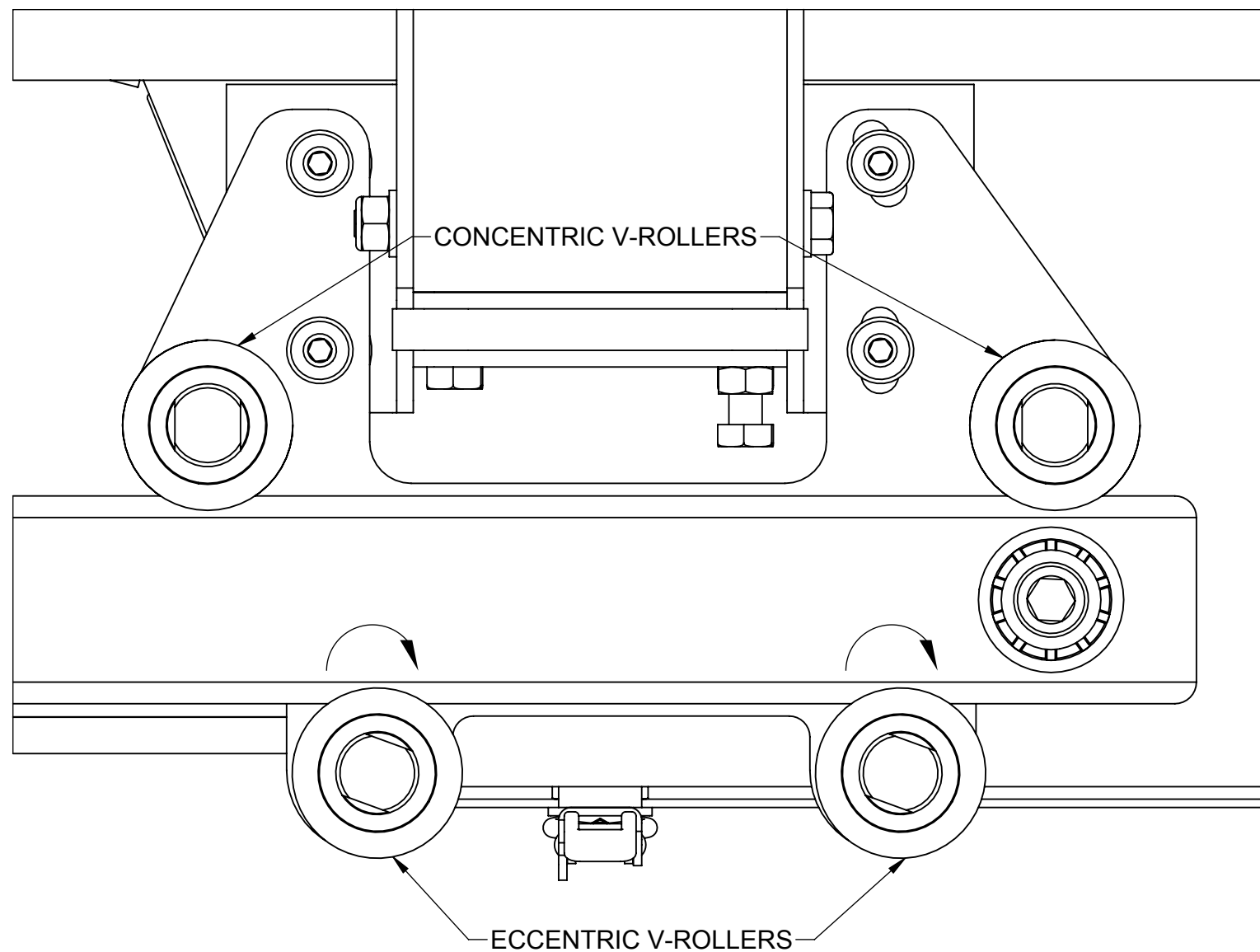

IF THE BLADE GUIDE ARM IS TIGHT IN THE V-ROLLERS OR UNABLE TO SLIDE IN BETWEEN THE V-ROLLERS, THE LOWER TWO (ECCENTRIC) V-ROLLERS NEED TO BE ROTATED CLOCKWISE (DOWNWARDS). LOOSEN THE LOCK NUTS ON THE OTHER SIDE OF THE CARRIAGE PLATE AND ROTATE THE V-ROLLER CLOCKWISE (DOWNWARD) SO THE V-ROLLERS MAKE PROPER CONTACT WITH THE BLADE GUIDE ARM. SECURE THE LOCK NUTS.

INDEX PLUNGER ADJUSTMENT

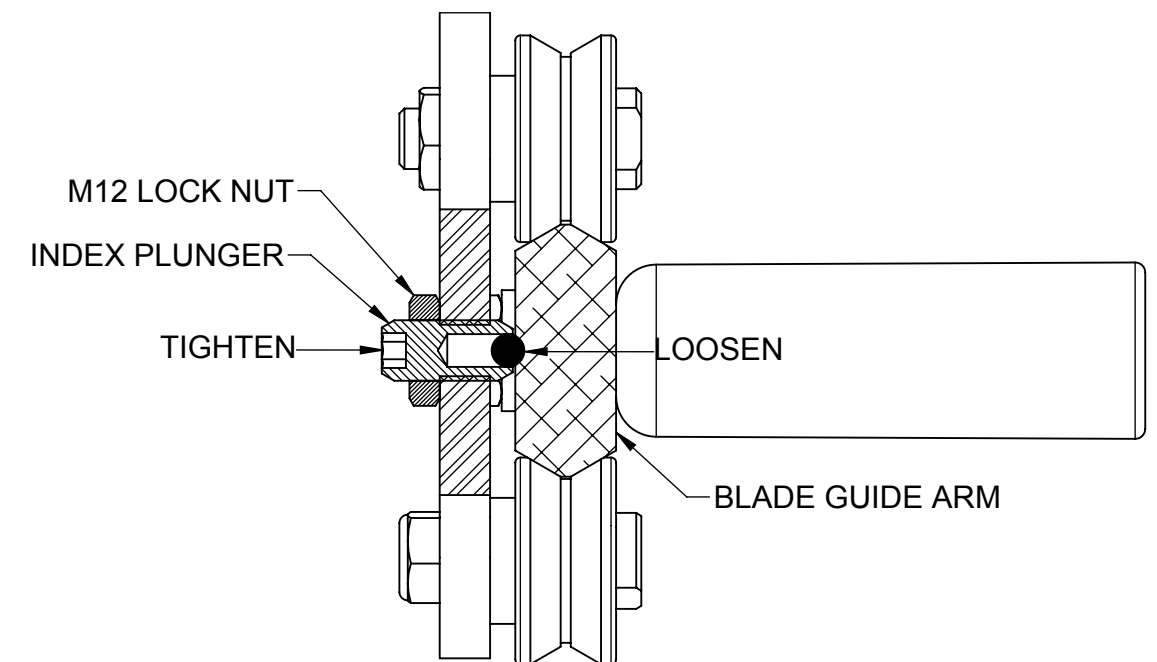
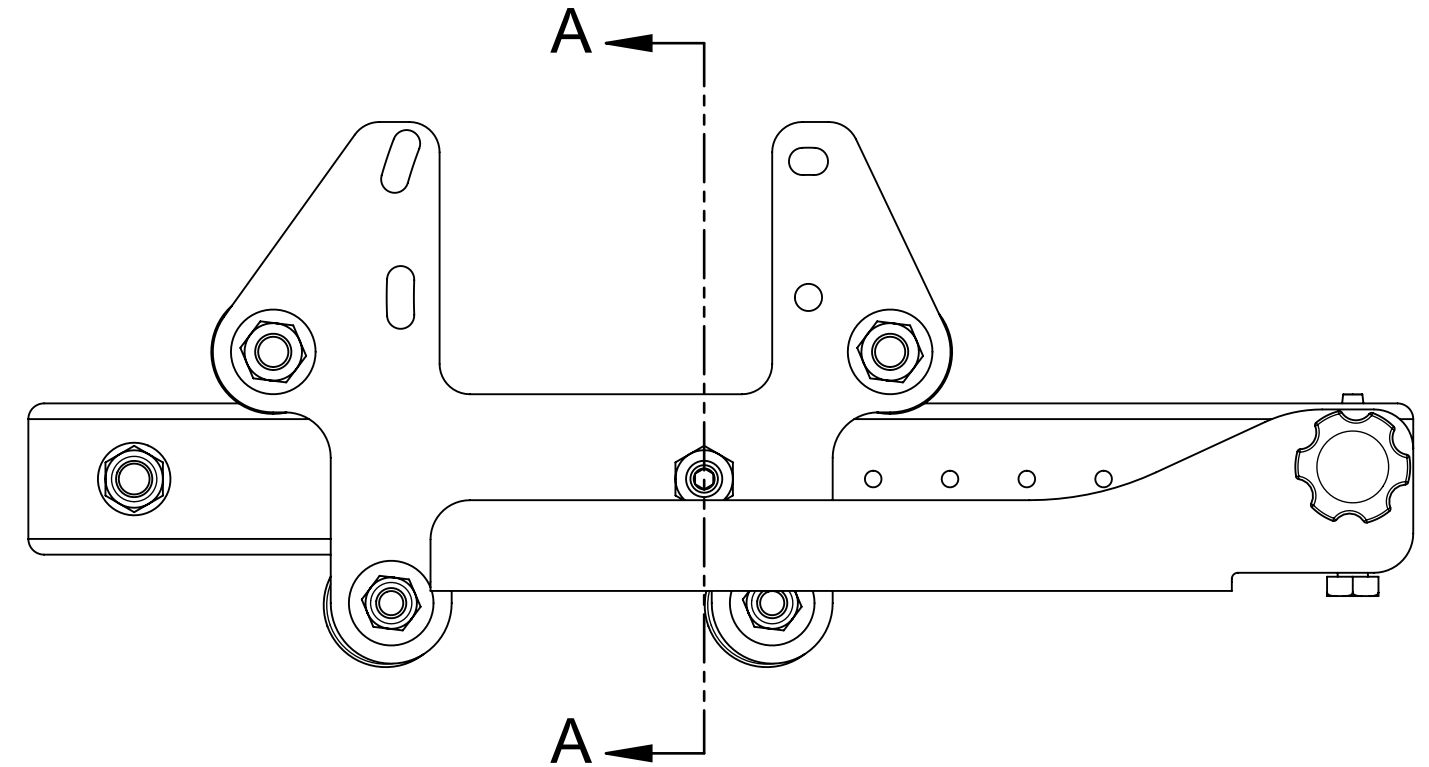
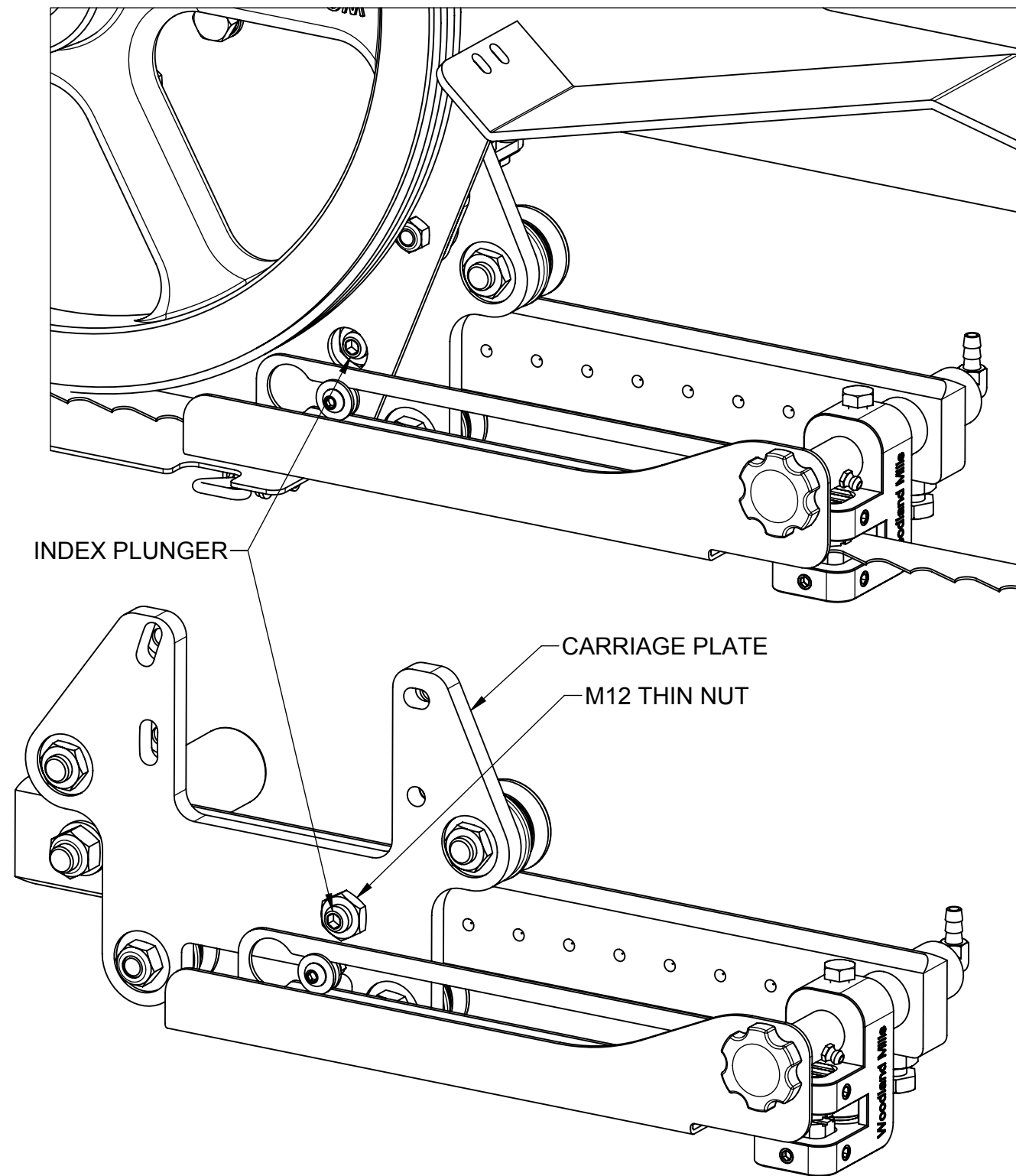

SECTION A-A

IF THE ADJUSTABLE BLADE GUIDE FEELS EITHER TOO STIFF OR IS NOT LOCKING IN PLACE, THE INDEX PLUNGER NEEDS TO BE ADJUSTED. USING A WRENCH IN BETWEEN THE BANDWHEEL HOUSING AND THE ADJUSTABLE BLADE GUIDE CARRIAGE PLATE, LOOSEN THE M12 THIN NUT.

IF THE ADJUSTABLE BLADE GUIDE IS TOO STIFF, LOOSEN (TURN COUNTER-CLOCKWISE) THE INDEX PLUNGER USING A HEX DRIVE. SECURE THE INDEX PLUNGER IN PLACE WITH THE M12 LOCK NUT.

IF THE ADJUSTABLE BLADE GUIDE IS NOT ENGAGING THE INDEX PLUNGER, TIGHTEN (TURN CLOCKWISE) THE INDEX PLUNGER USING A HEX DRIVE. SECURE THE INDEX PLUNGER IN PLACE WITH THE M12 LOCK NUT.